

# INDOOR DIGITAL SIGNAGE

## VIDEO WALL TYPE SCREEN

CLASS

MODEL

55" D55UFN

### KEY FEATURES

- Ultra Narrow Bezel
- Power Consumption Reduced at 40% Compared to Normal Display
- Built in Video Wall Function
- Portrait / Landscape Orientation
- High Connectivity
- UHD Resolution Daisy Chain
- USB Plug & Play (JPG & MP4)
- High Fidelity Audio Output (SPDIF)
- Remote Control (RS232)



# HYUNDAI

## Broadcast your branding with Hyundai Digital Signage!

According to the advanced product design, Hyundai Digital Signage Display meets necessary requirements for various digital signage solutions. LED BLU products of Hyundai IT can be up to 40 percent more energy saving compare to normal display, and environmentally friendly for the Eco-display.



# HYUNDAI

### SPECIFICATIONS

Model	D55UFN
Screen Size (diagonal)	55"
Active Display Area (in   mm)	47.62 x 26.79   1209.6 x 680.4
Resolution	1920 x 1080
Aspect Ratio	16:9
Display Colors	1.06 B
Brightness (cd/m²: typ.)	700
Contrast Ratio	1400 : 1
Response Time (ms: GTG)	12
Viewing Angle	178° / 178°
Lifetime (hours)	60,000
Backlight type	LED
Resolution	1920 x 1080
Input	1 x DP(Optional)   1xVGA   2xHDMI   1xDVI   1xPC Audio   1xRS232C   1xUSB(MMP)   1xRJ45(Optional)
Media Player (USB)	Movie: MPEG-2   MPEG-4 Photo: JPEG   PNG   BMP Music: MP3
Output	1xHDMI   1xIR   1xRS232C   Audio-Line Out   1xRJ45(Optional)
Power	Input Voltage: 100 - 240V AC Power consumption: 261 W
Features	Multi-screen function (Loop): HDMI   IR   RS232C Auto Cooling System: Yes Auto Power Control: Yes
Operation	Temperature (°C): 0 - 40 Humidity (%): 20 - 80 OSD Language: 12 Lang
Dimension	Set Size : W x H x D (inch   mm): 47.85 x 27.02 x 4.62   1213.4 x 684.2 x 100 Bezel to Bezel Size (inch   mm): 0.14   3.5 Active to Active Size (inch   mm): 0.15   3.8 Wall Mounting hole : WxH (mm): 600 x 400 / 600 x 200
Weight	Set (lb   kg): 74.96 / 34

Specifications and design are subject to change without notice. See our website for detailed information.

**HEAD OFFICE - HYUNDAI IT CO., LTD.**  
5F, 36, Sangil-ro 10-gil, Gangdong-gu, Seoul, 05288 Korea  
Tel. +82 70 7008 0151 E-mail: ssoh@hdit.co.kr  
www.hdit.co.kr

**HYUNDAI IT AMERICA CORP.**  
2051 Junction AVE., Suite 112 San Jose, CA 95131, USA  
Tel. +1 408 954 8920 email : sales@hyundaita.com  
www.hyundait.com

**HYUNDAI IT EUROPE GMBH**  
Borsig Str. 11-13  
65205 Wiesbaden, Germany  
Tel. +49(0) 6122-70342-10 email : info@hyundait.eu  
www.hyundait.eu

## VIDEO WALL TYPE SCREEN

MODEL

CLASS

D55UFN 55"

### FEATURES

#### LED Backlight

HYUNDAI's public displays with LED backlight bring the advantage of an up to 40% lower power consumption, compared to displays with CCFL backlight.

#### Ultra Narrow Bezel

Combined with the cutting edge function, Ultra narrow bezel design ensures a maximum screen area with unified images and a minimum of viewable interruptions.

#### Easy operating OSD menu, Remote control

In order to setup a multi display wall, the single units are linked by a daisy chain connection over DVI. The configuration of each display can be easily set-up over the on-screen menu or the RS232C interface.

#### 4K Daisy Chain

No more peripheral devices needed to configure 4K native video contents, HYUNDAI IT's display enables high-end 4K @60Hz video contents simply loop through the daisy chain without image distortion.

### DIMENSIONS

[ UNIT : mm [inch] ]

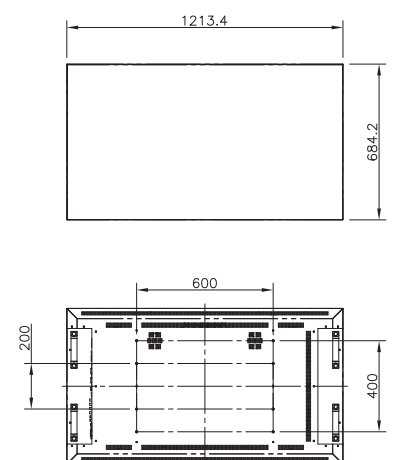

UPDATE: OCT. 2017